

BITUMINOUS TAPER (TYPICAL EACH END)

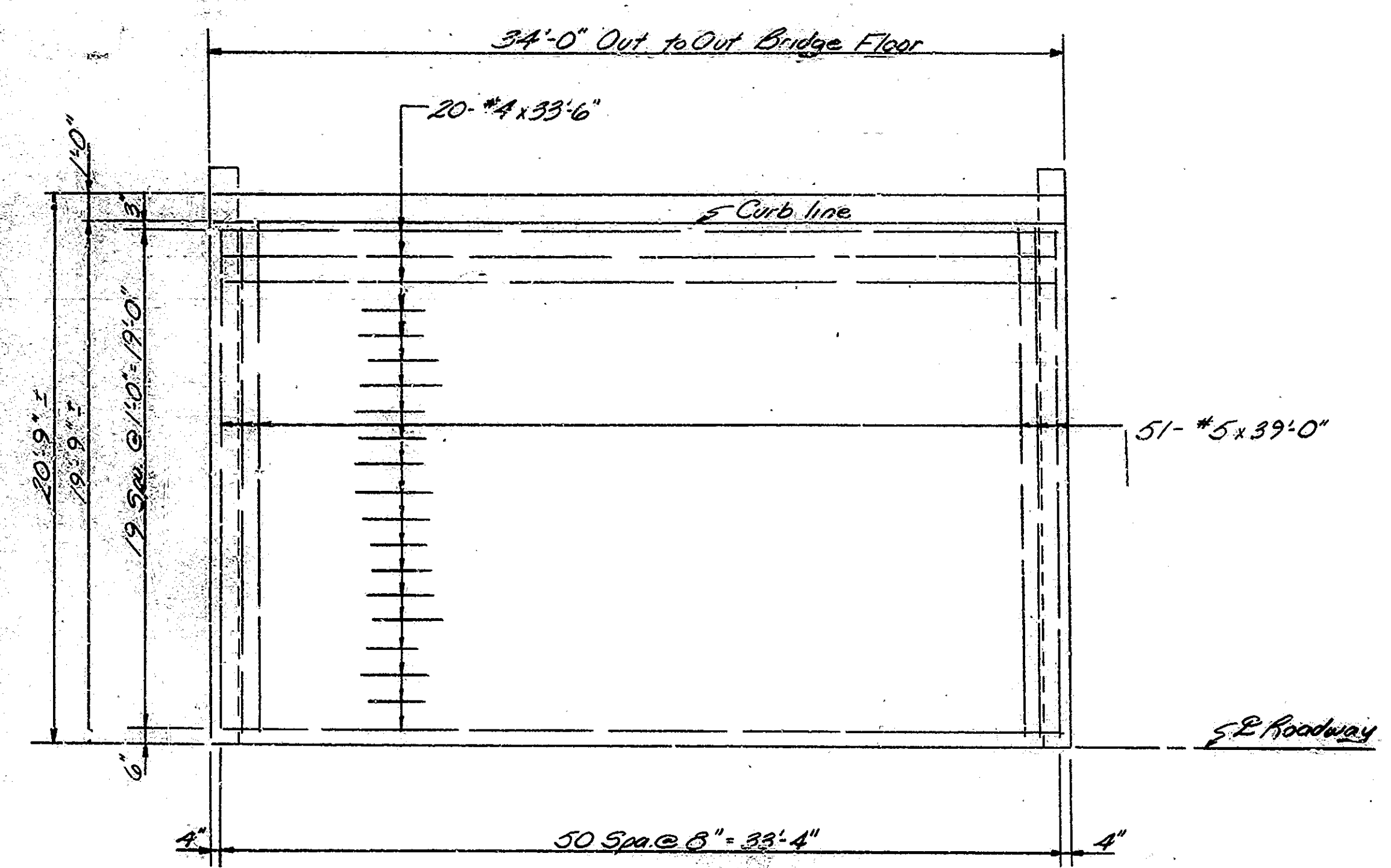

HALF PLAN
SCALE 1/4"=1'-0"

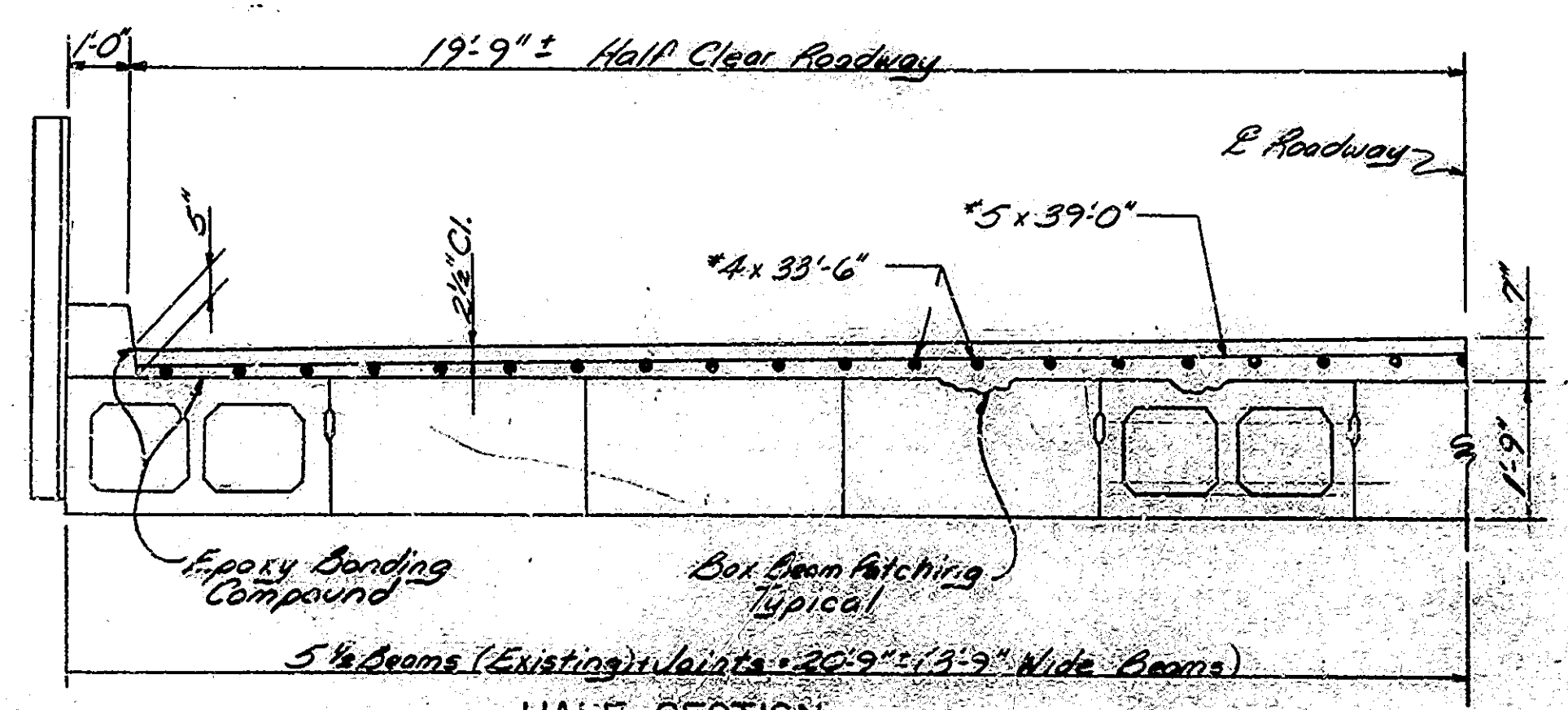

HALF SECTION
SCALE 1/2"=1'-0"

| | |
|----------|------|
| DESIGNED | CHKD |
| DRAWN | CHKD |
| TRACED | CHKD |

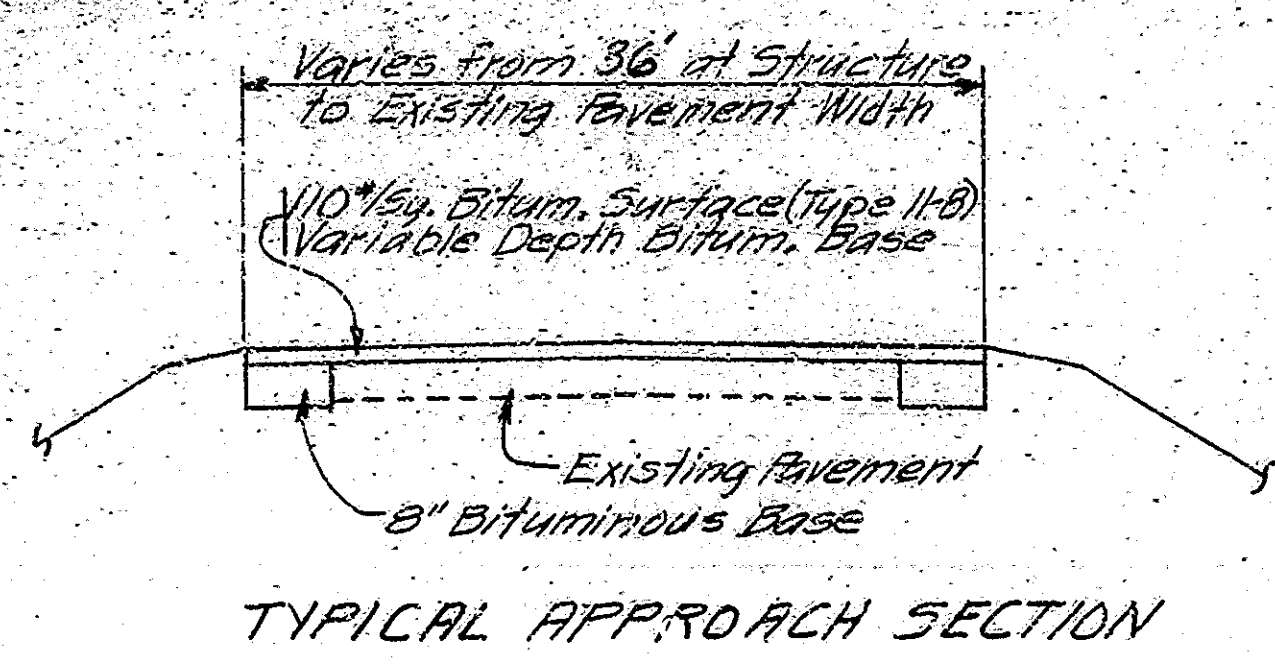

TYPICAL APPROACH SECTION

GENERAL NOTES

Reinforcing steel covering shall be 2 1/2 inches in top of floor slab.
 Where new work is to be fitted to old work, the Contractor shall check all dimensions and conditions in the field and report any errors or discrepancies to the Engineer and assume responsibility for their correctness and the fit of new part to old.
 The top of floor slab and the inside face and top of existing curbs to be surface sealed.
 All reinforcing steel to be Epoxy Coated.
 The deck reinforcing steel shall be securely tied down to prevent lifting during concrete placement.
 The Class C concrete slabs to be bonded to the cleaned beam surface with an epoxy bonding compound.
 Any beams so indicated on these plans are to be replaced. If necessary, adjacent beams will be replaced and reset. All deteriorated rods or dowels or any damaged in the removal process will be replaced by the Contractor. All grout joints between beams which are disturbed by the removal and replacement will be cleaned and repaired. The existing bearing devices are to be reused. All above items are to be included in the Lump Sum bid price for concrete structural members.
 The locations of the rod holes and the exact length and shear of the beams to be replaced will be determined in the field by the Contractor and this information will be furnished in writing to the fabricator and to the I&HC Bridge Design Section. The beams will be manufactured, shipped, and installed in accordance with the Standard Specifications and applicable I&HC Standard Drawings.
 The removal of bituminous surface and the concrete scarifying shall be accomplished in such a manner that no damage will occur to any beams and excess concrete will not be removed from any beams.

| INDEX | | | |
|-----------|-------------------|----------------------------------|--------|
| SHEET No. | SHEET DESIGNATION | SUBJECT | DATE |
| 1 | RI | Title Sheet & General Plan | |
| 2 | CI | Reinf. Bar Notes, Bar bending | |
| | PB 6 | Prestressed Box Beams | |
| | PB | Prest. Box Beams, Non-Comp. Wide | |
| | PB | | |
| | PB 10 | Tolerances for Prest. Beams | |
| 3 | Det. Sh. 1 | Standard Detour Signs | 5-1-78 |
| 4 | Det. Sh. 2 | Standard Detour Signs | 5-1-78 |
| 5 | Det. Sh. 2A | Standard Barricades | 4-1-77 |
| 6 | Det. Sh. 3 | Standard Detour Signs | 4-1-77 |
| 7 | Det. Sh. 4 | Standard Detour Signs | 4-1-77 |
| 8 | Det. Sh. 9 | Traffic Sign Details | 3-1-79 |
| 9 | CBE | Temporary Concrete Barrier | 2-1-79 |

ESTIMATE OF QUANTITIES

| CODE | ITEM | UNIT | QUANTITY |
|-------|---|------|----------|
| 51002 | Concrete, Class C in Superstructure | CYS. | 249 |
| 51032 | Epoxy Coated Reinforcing Steel | LBS. | 2910 |
| 51045 | Concrete Structural Members | LSUM | |
| 51328 | Removal of Present Structure (for form) | LSUM | |
| 52415 | Bituminous Surface Removal | SYS. | 149 |
| 51833 | Concrete Scarifying | SYS. | 149 |
| 51837 | Blasting and Cleaning | SYS. | 149 |
| | Box Beam Patching | SFT. | 45 |
| 51826 | Surface Seal | SFT. | 1445 |
| 52470 | Bituminous Mixture for Approaches | TON | 165 |
| 52340 | Construction Signs (Type A) | EACH | 12 |
| 52345 | Construction Signs (Type B) | EACH | 6 |
| 52350 | Standard Barricades (Type II) | EACH | 2 |
| 52456 | Bituminous Material for Tack Coat | SYS. | 845 |

RECOMMENDED FOR APPROVAL 4-17-79

William D. Alford
 ASSISTANT ENGINEER OF BRIDGE DESIGN
 INDIANA STATE HIGHWAY COMMISSION

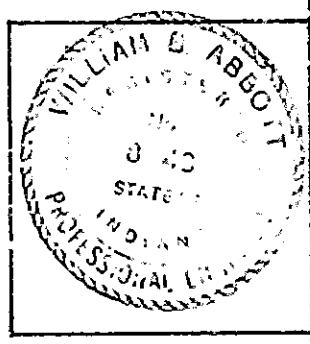

RECOMMENDED FOR APPROVAL 4-30-79

E. W. Walters
 ENGINEER OF BRIDGE DESIGN
 INDIANA STATE HIGHWAY COMMISSION

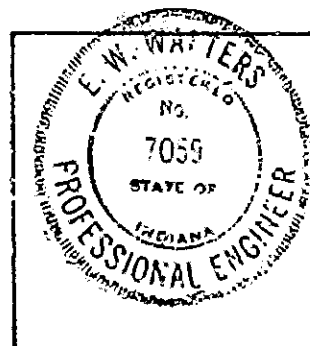

APPROVED 5-2-79

G. H. Haddock
 CHIEF HIGHWAY ENGINEER
 INDIANA STATE HIGHWAY COMMISSION

TITLE SHEET & GENERAL PLAN
 REPAIRS TO PRESTRESSED BOX BEAM BRIDGE
 1 SPANS @ 34'-0" 39'-6" CL. ROADWAY
 OVER Smith Shoemaker Ditch Square QM SR 218
INDIANA STATE HIGHWAY COMMISSION
 ADAMS COUNTY

SCALE: AS NOTED DATE: March 8, 1979

James R. Schick
 SENIOR DESIGNER

DRAWING: RI OF 1 SHEET: 1 OF 9
 PROJECT: ST-3801(C)
 CONTRACT NO. B-12125
 BRIDGE FILE: 218-01-6312 B

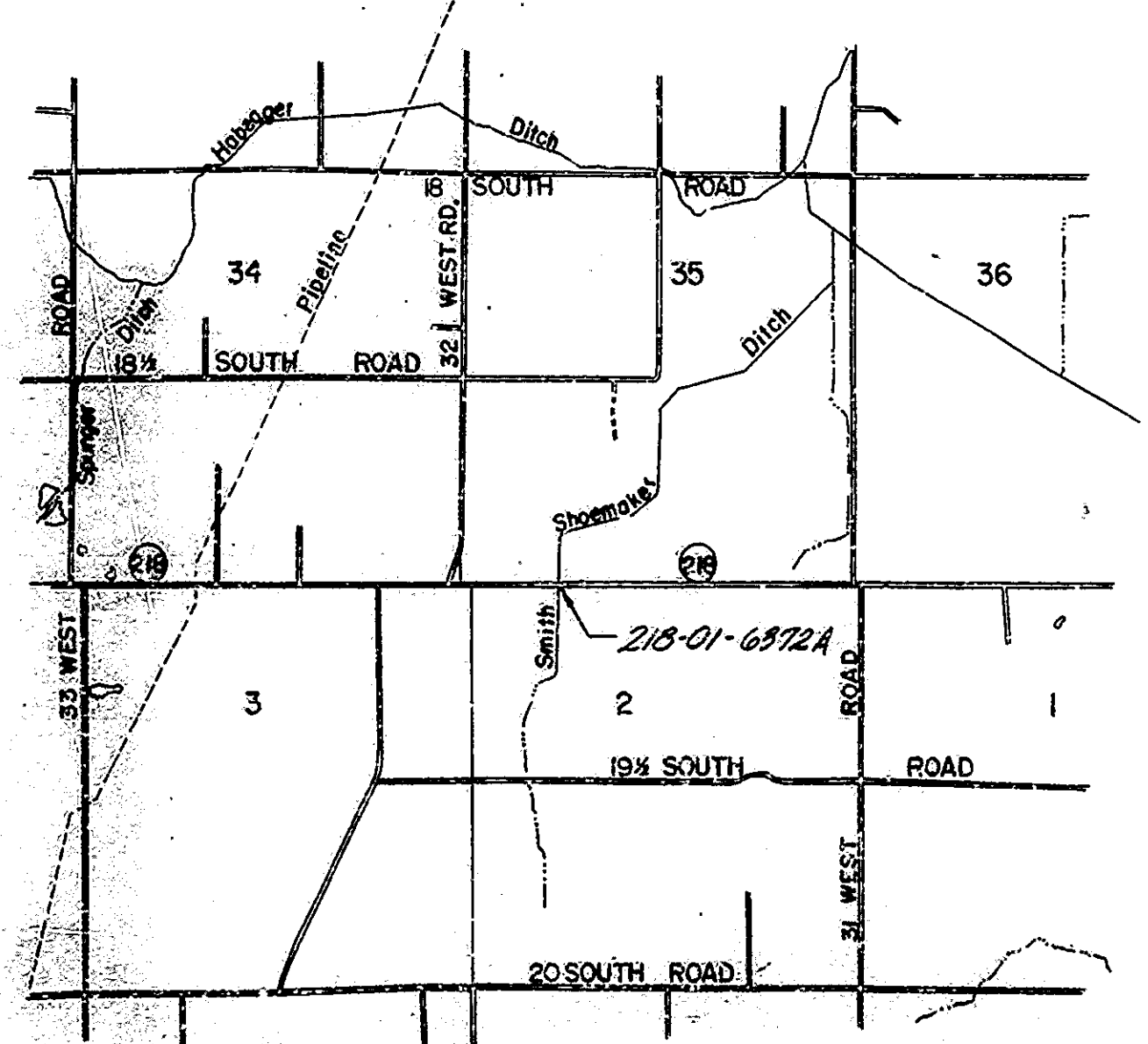
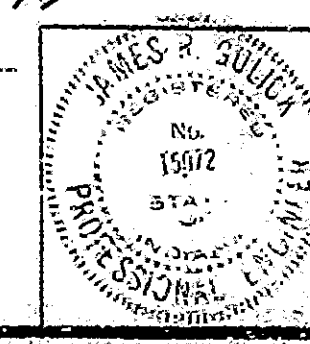

T.25N. & T.26N. R.14E. SECTION 2 & 35
 LOCATION PLAN